

AUTOMOTIVE FITTINGS SHALL MEET OR EXCEED THE LATEST REVISION OF THE FOLLOWING APPLICABLE SPECIFICATION[S]:

- A.] AUTOMOTIVE PIPE FITTINGS-SAE J530.
- B.] SPHERICAL AND FLANGED SLEEVE [COMPRESSION] TUBE FITTINGS-SAE J246.
- C.] AUTOMOTIVE TUBE FITTINGS-SAE J512.
- D.] CODING SYSTEMS FOR IDENTIFICATION OF FLUID CONDUCTORS AND CONNECTORS-SAE J846.
- E.] PERFORMANCE REQUIREMENTS FOR SAE J844d NONMETALLIC TUBING AND FITTING ASSEMBLIES USED IN AUTOMOTIVE AIR BRAKE SYSTEMS-SAE J1131.

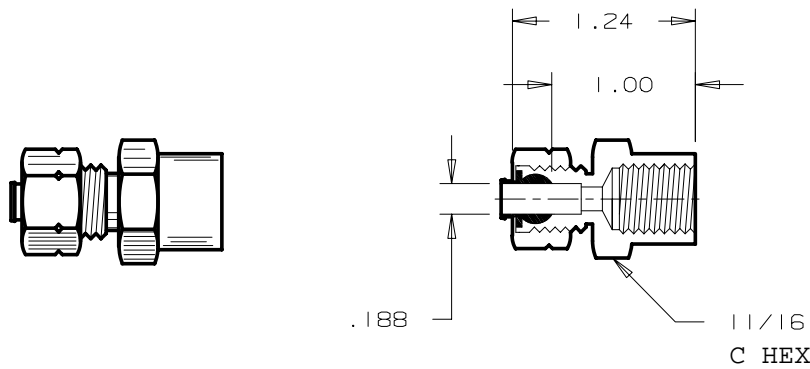

PRODUCT DESCRIPTION: BRASS-FEMALE CONNECTOR, 1/4 TUBE, 1/4 PIPE THREAD, 7/16-24 STRAIGHT THREAD, PARKER BRASS PRODUCTS DIVISION CATALOG PART NO. 66CA-4-4.

- (B) ANDERSON P/N: 966A-4B
- CAPITAL FASTENERS P/N: BRS966A-4B

CAD DRAWING
DO NOT
MAKE MANUAL
CHANGES

THIRD ANGLE PROJECTION		TOLERANCE UNLESS OTHERWISE NOTED			THOMAS BUILT BUSES, INC. HIGH POINT, NC WOODSTOCK, CANADA	
		DECIMAL	FRACTIONAL	ANGULAR		
B	ADDED ANDERSON AND CAP. FAST. PARTNUMBERS	.XXX	.015			FITTING - FEMALE CONNECTOR, BRASS, 1/4 TUBE, 1/4 PIPE THREAD, 66CA-4-4
		.XX	.03	±1/32	±1/2°	
		.X	.06			DRN. 10/06/93 BY JGS MAT'L
						CK'D. 10/06/93 BY PAW SIZE
						MFG. BY DWG. NO.
	* REV A ERN# B-9811 *					2A 29980092
LET	REVISION		DATE	BY	CF	SCALE FULL